

AVG Series D135mm Large Revolving Warning Signal Light



Rust-free plastic Revolving Warning Light for a wide range of applications. Ideal for large machines, construction sites, parking systems and more.



- Incandescent type
- Red, Yellow, Green and Blue lens available
- Smooth lens
- Extended Product Life
- Stud mounted
- Optional Wall Mounting Brackets available
- Buzzer(80dB) Model available

Ordering Information

AVG **B** - **20** - **R**
 ① ② ③

1. Light Style

	Rotating Light
B	Rotating Light + Buzzer

2. Power Supply

01	12VDC
02	24VDC
10	110VAC
20	220VAC

3. Lens Colors

R	Red
Y	Yellow
G	Green
B	Blue

Optional Orders

Replacement Bulb

Rated Voltage	Bulb	Rated Voltage	Bulb
12V DC	12V 25W	110V AC	130V 25W
24V DC	24V 25W	220V AC	240V 25W

▶ See page 44 for Replacement Bulbs product

Wall mount bracket for AVG series.

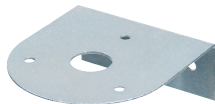

MAM-DS27
Steel

See Page 56 - 58 for Mounting Options and Accessories.

Wiring Diagram

▶ 12VDC , 24VDC

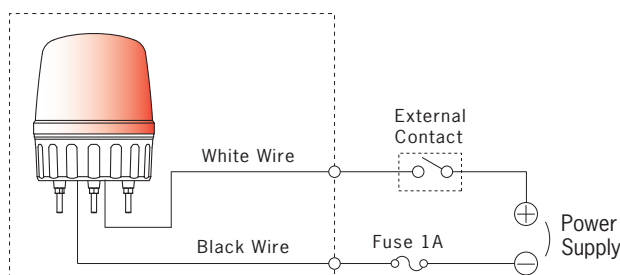

▶ 110VAC , 220VAC

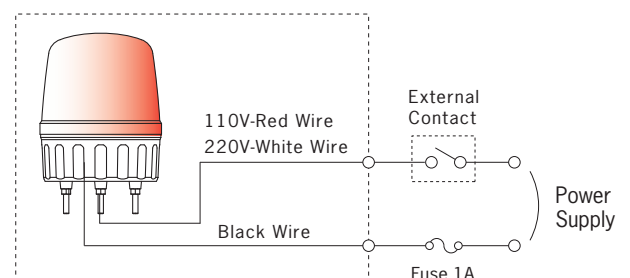

Specifications

Operation/Function	Rotating , Buzzer
Power Supply	12VDC , 24VDC 110VAC (50/60Hz) , 220VAC (50/60Hz)
Lens Diameter	135 mm
Lens Color	Red, Yellow, Green, Blue (Lens Type : Smooth)
Rotation Rate	150times/minute ±10%
Buzzer Sound Level	80±5dB (at 1M)
Ambient Temperature	-15 to 40°C
Storage Temperature	-20 to 70°C
Ambient Humidity	45 ~ 85% RH
Degree of Protection	IP42
Approvals	UL, CE, RoHS
Recommended Wire Size	110/220V: 1007 UL / 18AWG 12/24V: 1007 UL / 22AWG

Current Draw

Power Supply	12VDC	24VDC	110VAC	220VAC
Current Draw	2.08A, 25W	1.04A, 25W	0.22A, 25W	0.11A, 25W

Dimensions (unit: mm)

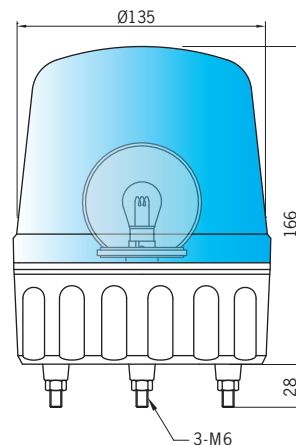

▶ Hole Mounting

